

Technical data sheet

Clamp clip, single, FT plastic pressure trough

Item number: 1175408



Suitable for all C profile rails with slot width 18 mm and 22 mm.

Polypropylene pressure trough, halogen-free, colour light grey RAL 7035.



St Steel

FT Hot-dip galvanised

Master data

| | |
|-----------------------------------|-------------------------|
| Item number | 1175408 |
| Description 1 | Clamp clip |
| Manufacturer | OBO |
| Dimension | 34-40mm |
| Material | Steel |
| Surface | Hot-dip galvanised |
| Surface standard | DIN EN ISO 1461 |
| Smallest sales unit | 100 |
| Unit of quantity | Piece |
| Weight | 8.1 kg |
| Weight unit | kg/100 pc. |
| CO Footprint (GWP) Cradle-to-Gate | 0,1451 kg COe / 1 Piece |

Technical data sheet

Clamp clip, single, FT plastic pressure trough

Item number: 1175408



Dimensions

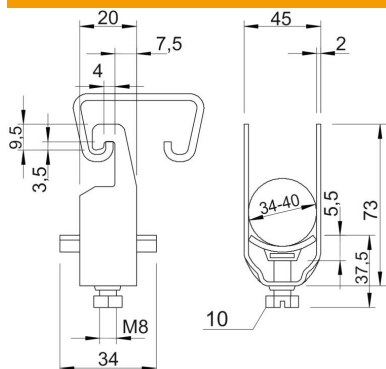

| | |
|------------------|---------|
| Dimension A | 20 mm |
| Dimension B | 45 mm |
| Dimension C | 34 mm |
| Dimension G (mm) | M8 |
| Dimension H | 73 mm |
| Dimension L | 37.5 mm |
| Dimension t | 2 mm |
| Dimension x | 5.5 mm |

Technical data

| | |
|--|----------------|
| Number of cables/pipes | 1 |
| for 1 cable H | 73 mm |
| for 1 cable L | 37.5 |
| for 2 cable H | 115 mm |
| for 2 cable L | 44.5 mm |
| for 3 cable H | 157 mm |
| for 3 cable L | 44.5 mm |
| For pipe diameter, max. | 40 mm |
| For pipe diameter, min. | 40 mm |
| for rail with slot width (with interval), max. | 22 mm |
| for rail with slot width (with interval), min. | 18 mm |
| Halogen-free | yes |
| Max. Tightening torque | 5 Nm |
| With plastic trough | yes |
| With metal trough | no |
| Mounting type | Profile rail |
| Impact-resistant | no |
| Clamping range D, max. | 40 mm |
| Clamping range D, min. | 34 mm |
| Surface addition | hot galvanised |
| Material addition | Steel |
| With counter-trough | no |
| Material of trough | Plastic |
| Material quality of trough | Polypropylene |